

CEL-FI[®] CONNECT C41 Quick Start Guide

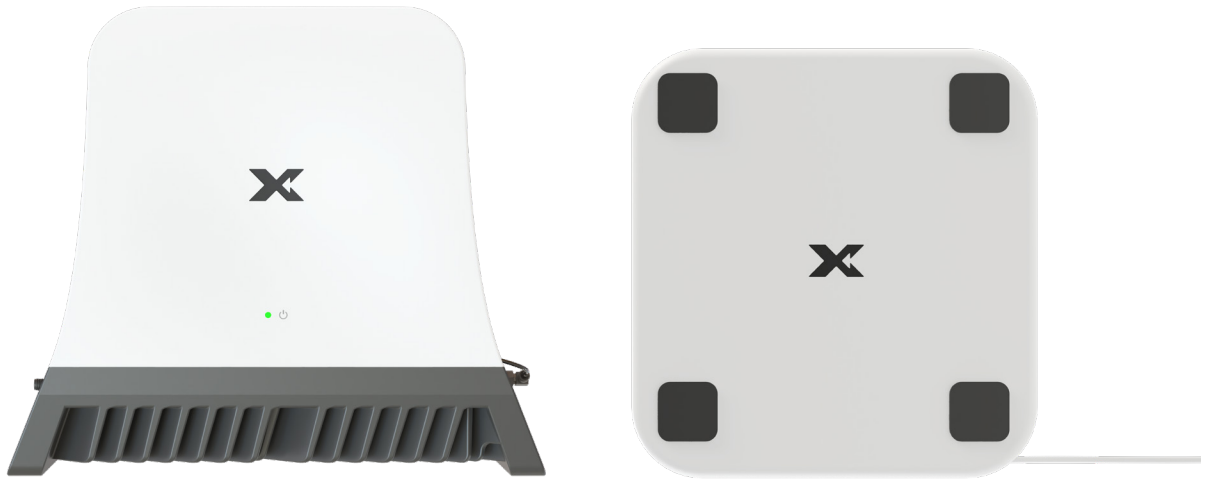

M/N:

C41-9B-00C	C41-9B-003
C41-JB-00C	C41-JB-003
C41-KB-00C	C41-XB-00C

Included In the Box

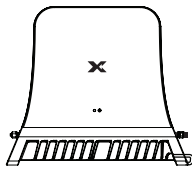

Main Unit

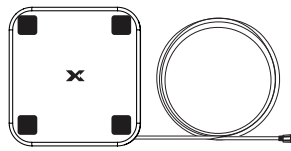

Donor Antenna*

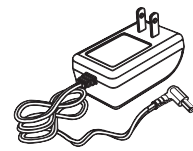

AC Adapter

Mounting Screws (4)
Drywall Anchors (4)

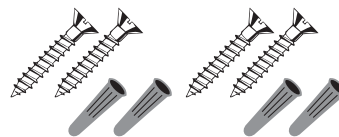

** Included with certain kits only*

Quick Installation

IMPORTANT: Your CEL-FI CONNECT C41 is an electronic device. It must be kept indoors and in a dry, cool, well-ventilated area.

1

Select Donor Antenna Location

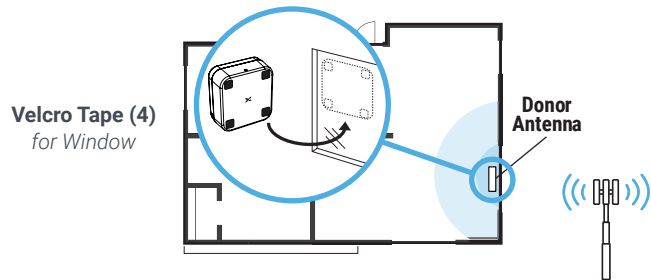

Use your phone to find the window with the best cellular signal. Install the **Donor Antenna** on this window by removing the four adhesive covers and sticking them to the glass.

2

Select Main Unit Location

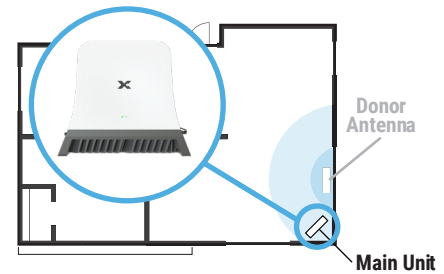

Selecting the ideal location for the **Main Unit** is important to ensure your system provides reliable coverage. The **Main Unit** should be isolated from the **Donor Antenna**, with greater separation providing best performance. Make sure the Nextivity logo on the **Main Unit** faces where coverage is needed and away from the **Donor Antenna**.

3

Attach Cables

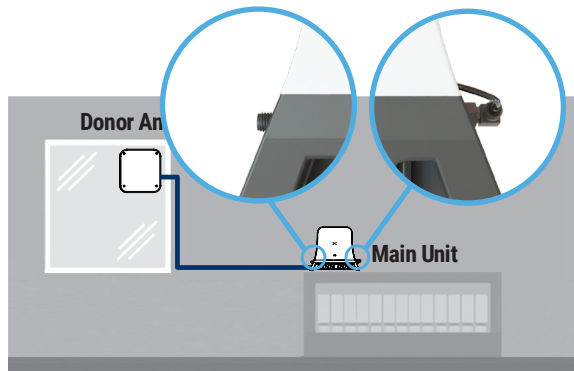

Attach the cable from the **Donor Antenna** to the Donor Port on **Main Unit**.

Attach the short cable coming out of the **Main Unit** to the Server Port on the base of the unit

4

Plug In the Main Unit

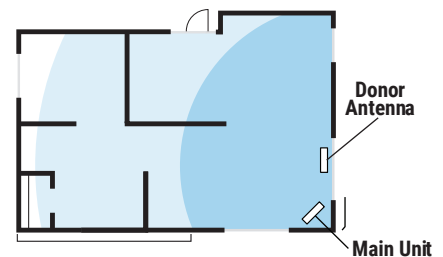
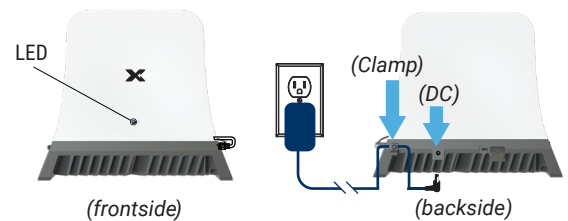

Plug in the **Main Unit** to power with the included AC adapter. Attach the power cable clamp to manage the AC adapter cable. The LED on the front will blink during set up and turn green when the device is ready.

5

Configure with the WAVE App

The **WAVE App** can be used to review your installed system's performance, including viewing real-time signal strength.



Scan to Download:

The **WAVE App** is available for smartphones and tablets.

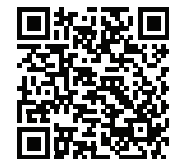

Ceiling Mounting Instructions *(Optional)*

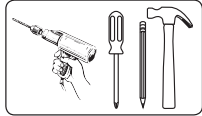

REQUIRED HARDWARE

NOTE: This package comes equipped with **Mounting Screws** and **Drywall Anchors** for mounting to the ceiling. Before installing, ensure there are no wires, other objects, or metal plates above the drywall that may interfere with the inserts, screws, or mounted units.

1 Make sure the **Donor Antenna** cable (16.4 ft/5 m) and **AC Adapter** cable (6 ft/1.85 m) both can reach the respective ports on the **Main Unit** at the ceiling mounting location selected. (Refer to the Quick Installation section)

2 Mark the 4x mounting hole locations to drill.

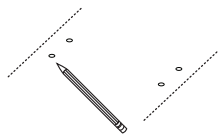

3 In each marked spot, use a 3/16" drill bit to drill guide holes for mounting screws.

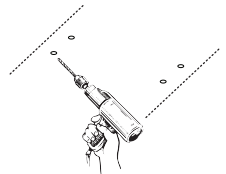

4 Install the **Drywall Anchors** and **Mounting Screws** with the **Main Unit**. Continue with Step 3 of Quick Installation instructions.

*Mounting Screws (4)
Ceiling Mount Option*

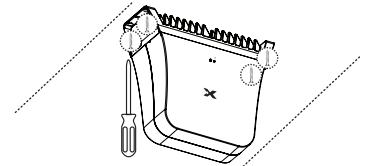

M/N	Bands Supported	Link	Output Power (dBm)
C41-9B	1, 3, 7	Uplink	22
		Downlink	10
	8, 20	Uplink	20
		Downlink	10
C41-JB	1, 3, 7, 40	Uplink	22
		Downlink	10
	5, 8, 28L	Uplink	20
		Downlink	10
C41-KB	3	Uplink	22
		Downlink	10
	8, 20	Uplink	20
		Downlink	10
C41-XB	1, 3	Uplink	22
		Downlink	10
	8	Uplink	20
		Downlink	10